



# UN100-12L (12V100Ah)



UN100-12L is a general purpose battery with 10 years floating design life, meet with IEC, JIS .BS and Eurobat standard. With heavy duty grid, thickness plates, special additives, UN series battery have long and reliable standby service life. Our UN Series batteries keep high consistent for better performance in series usage.

## Specification

<b>Cells Per Unit</b>	6
<b>Voltage Per Unit</b>	12
<b>Capacity</b>	100Ah@10hr-rate to 1.75V per cell @25°C
<b>Weight</b>	Approx.29.0 Kg
<b>Max. Discharge Current</b>	1000A (5 sec)
<b>Internal Resistance</b>	Approx. 5.5m Ω
<b>Operating Temperature Range</b>	Discharge: -20°C~60°C Charge: 0°C~50°C Storage: -20°C~60°C
<b>Normal Operating Temperature Range</b>	25°C±5°C
<b>Float charging Voltage</b>	13.6 to 13.8 VDC/unit Average at 25°C
<b>Recommended Maximum Charging Current Limit</b>	30 A
<b>Equalization and Cycle Service</b>	14.6 to 14.8 VDC/unit Average at 25°C
<b>Self Discharge</b>	Valve Regulated Lead Acid (VRLA) batteries can be stored for more than 6 months at 25°C. Self-discharge ratio less than 3% per month at 25°C. Please charge batteries before using.
<b>Terminal</b>	Terminal F5/F12
<b>Container Material</b>	A.B.S. (UL94-HB), Flammability resistance of UL94-V1 can be available upon request.

## Dimensions

Unit: mm Dimension: 328(L)×172(W)×222(H)

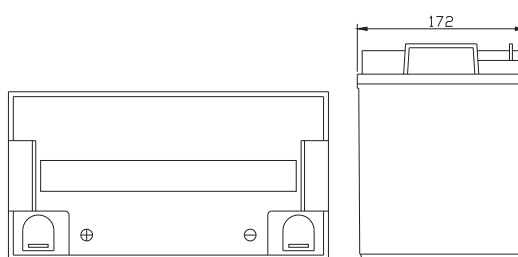
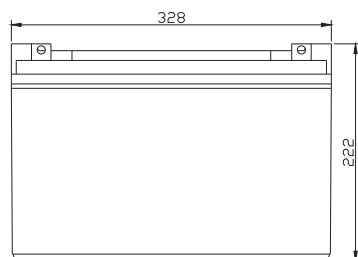

Terminal F12

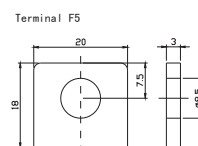
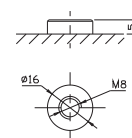

### Constant Current Discharge Characteristics: A (25°C)

F.V/Time	5MIN	10MIN	15MIN	30MIN	1HR	2HR	3HR	4HR	5HR	8HR	10HR	20HR
9.60V	299.1	213.7	170.9	106.1	61.85	37.01	25.58	20.96	17.16	11.82	9.99	5.33
10.0V	290.5	203.3	167.4	104.4	61.56	36.73	25.48	20.87	17.06	11.72	9.90	5.23
10.2V	281.9	196.2	164.8	103.5	60.99	36.45	25.28	20.77	16.96	11.63	9.80	5.14
10.5V	253.1	181.0	156.9	100.9	60.42	36.17	25.19	20.57	16.75	11.53	9.71	5.04
10.8V	228.4	165.1	144.6	96.4	58.99	35.52	24.50	20.09	16.45	11.34	9.61	4.94
11.1V	195.1	147.5	129.7	90.4	56.04	33.95	23.42	19.12	15.75	10.86	9.32	4.65

### Constant Power Discharge Characteristics: W(25°C)

F.V/Time	5MIN	10MIN	15MIN	30MIN	1HR	2HR	3HR	4HR	5HR	8HR	10HR	20HR
9.60V	3094	2276	1880	1210	714.7	436.2	304.4	249.9	204.7	141.1	119.4	63.92
10.0V	3033	2206	1850	1195	713.0	433.9	304.5	249.6	204.2	140.4	118.7	62.81
10.2V	2998	2148	1829	1187	707.4	431.3	303.2	249.0	203.5	139.5	117.6	61.65
10.5V	2730	2000	1745	1159	701.1	428.1	302.0	246.7	201.1	138.4	116.5	60.49
10.8V	2486	1844	1612	1111	688.2	422.7	293.8	241.1	197.4	136.1	115.3	59.32
11.1V	2184	1667	1451	1044	658.7	407.0	281.1	229.4	188.9	130.3	111.8	55.84

All mentioned values are average values.

# UN100-12L

12V100Ah



## Effect of temperature on long term float life

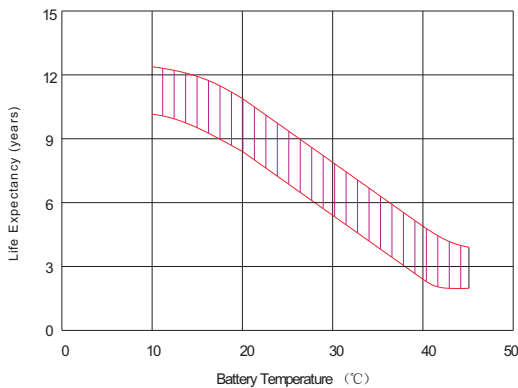

## Storage characteristic

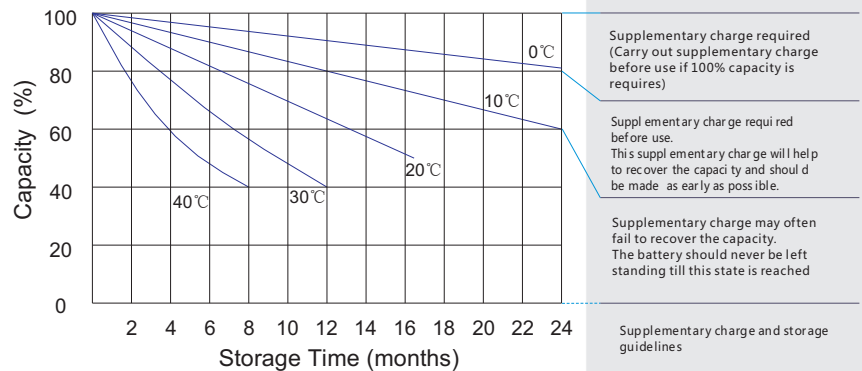

## Charge characteristic Curve for standby use

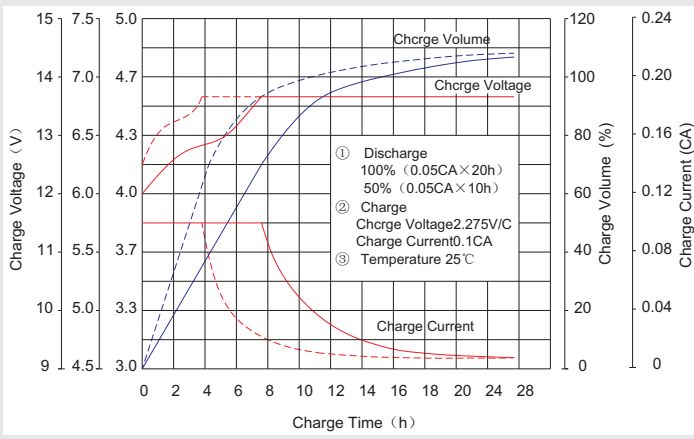

## Discharge characteristic Curve

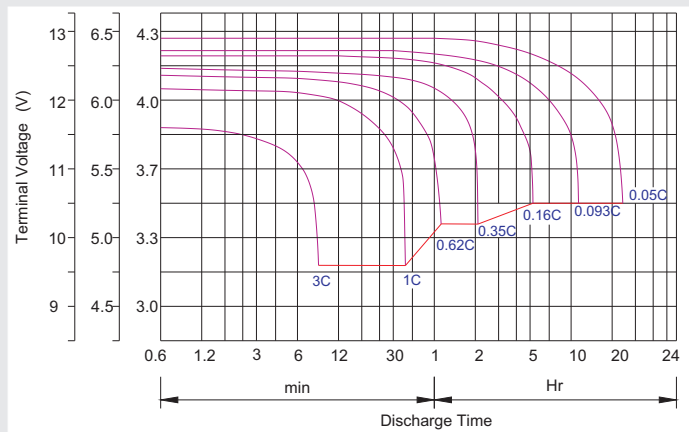

## Capacity Factors With Different Temperature

Battery Type		-20°C	-10°C	0°C	5°C	10°C	20°C	25°C	30°C	40°C	45°C
GEL Battery	6V&12V	50%	70%	83%	85%	90%	98%	100%	102%	104%	105%
	2V	60%	75%	85%	88%	92%	99%	100%	103%	105%	106%
AGM Battery	6V&12V	46%	66%	76%	83%	90%	98%	100%	103%	107%	109%
	2V	55%	70%	80%	85%	92%	99%	100%	104%	108%	110%

## Discharge Current VS. Discharge Voltage

Final Discharge Voltage V/cell	1.75V	1.70V	1.60V
Discharge Current (A)	(A) ≤ 0.2C	0.2C < (A) < 1.0C	(A) ≥ 1.0C

**Charge the batteries at least once every six months, if they are stored at 25°C.**

Charging Method:

Constant Voltage	-0.2Cx2h+2.4-2.45V/cellx24h, Max. Current 0.3CA
Constant Current	-0.2Cx2h+0.1CAx12h
Fast	-0.2Cx2h+0.3CAx4.0h

## Maintenance & Cautions

### Float Service:

- ※ Every month, recommend inspection every battery voltage.
- ※ Every three months, recommend equalization charge for one time.

Equalization charge method:

Discharge: 100% rate capacity discharge.

Charge: Max. current 0.3CA, constant voltage 2.4-2.45V/Cell charge 24h.

- ※ Effect of temperature on float charge voltage: -3mV/°C/Cell.

- ※ Length of service life will be directly affected by the number of discharge cycles, depth of discharge, ambient temperature and charging voltage.