

Solar Modules with 36 Cells

Mono-Crystalline

SRM75D~90D

| Module Type | Number of Cell | Cell Dimension (mm) | Max System Voltage(V) | Pm(W) | Vm(V) | Im(A) | Voc(V) | Isc(A) |
|-------------|----------------|---------------------|-----------------------|-------|-------|-------|--------|--------|
| SRM-75D | 36 | 125×125 | DC700 | 75 | 17.8 | 4.22 | 21.7 | 4.62 |
| SRM-80D | 36 | 125×125 | DC700 | 80 | 18.2 | 4.40 | 22.1 | 4.87 |
| SRM-85D | 36 | 125×125 | DC700 | 85 | 18.5 | 4.59 | 22.2 | 5.13 |
| SRM-90D | 36 | 125×125 | DC700 | 90 | 18.5 | 4.86 | 22.3 | 5.37 |

Poly-Crystalline

SRM75P~85P

| Module Type | Number of Cell | Cell Dimension (mm) | Max System Voltage(V) | Pm(W) | Vm(V) | Im(A) | Voc(V) | Isc(A) |
|-------------|----------------|---------------------|-----------------------|-------|-------|-------|--------|--------|
| SRM-75P | 36 | 125×125 | DC700 | 75 | 17.5 | 4.29 | 21.5 | 4.65 |
| SRM-80P | 36 | 125×125 | DC700 | 80 | 17.8 | 4.49 | 21.6 | 4.91 |
| SRM-85P | 36 | 125×125 | DC700 | 85 | 18.1 | 4.70 | 21.7 | 5.20 |

Picture



SRM75D~90D

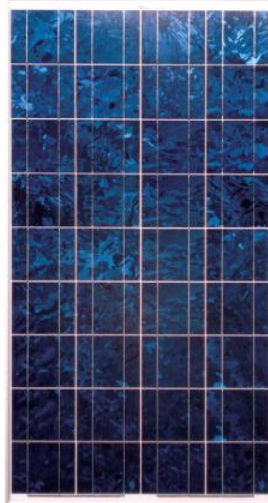

SRM75P~85P

Structure

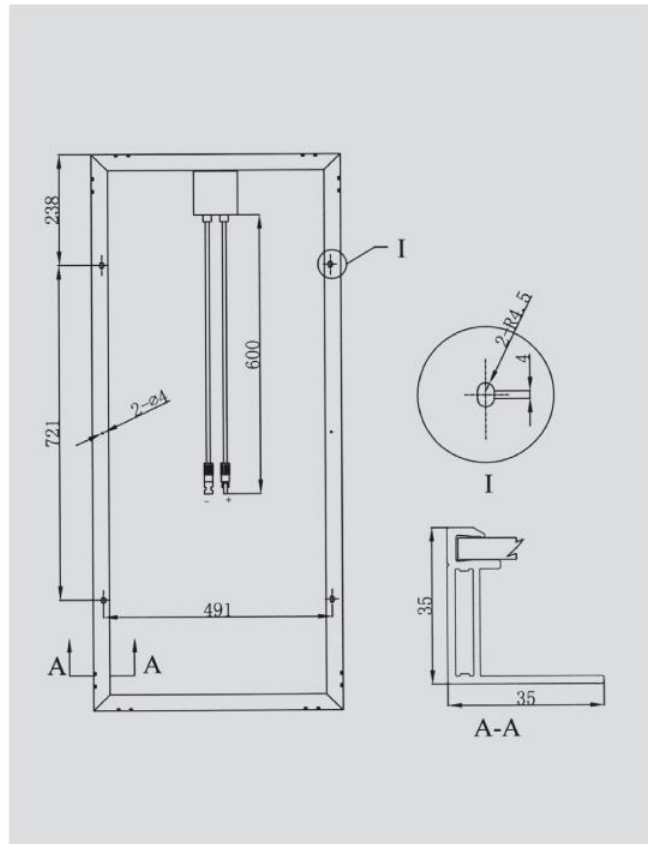

Physical Characters

| | |
|-----------------------|---|
| Module Net Weight | 9.2(kg) |
| Module Size | 1197×535×35(mm) |
| Carton Size | 1230×570×90(mm) |
| Packing Configuration | 2pcs/carton 19cartons/pallet |
| Loading Capacity | 456pcs/12pallets/20' container 1026pcs/27pallets/40' container |

TO CREATE A SUSTAINABLE FUTURE
创造可持续发展的未来

常州兆阳光能科技有限公司
SUNRISE SOLARTECH CO., LTD.

地址: 常州市钟楼开发区科技工业园星港路65-22号

电话: 0086-519-83906509(总机)

0086-519-83906507(贸易部)

传真: 0086-519-83906508

网址: www.srsolartech.com

Add: No. 65-22 Xinggang Road, Zhongliou Development

Zone, Changzhou 213023 Jiangsu, P. R. China

Tel: 0086-519-83906509 0086-519-83906507

Fax: 0086-519-83906508

Http: //www.srsolartech.com